

Bomanite Exposed Aggregate Systems

PROJECT PROFILE

BARTLE HALL BALLROOM WATER PLAZA



PROJECT INFORMATION

Bartle Hall Convention Center (often referred to as the "Kansas City Convention Center" or simply Bartle Hall) is a major exposition hall in downtown Kansas City, Missouri. It is named for Harold Roe Bartle, a prominent, two-term mayor of Kansas City in the 1950s and early 1960s.

The City Council agreed to a \$1 million city contract for new public art at the Bartle Hall ballroom expansion.

The Japanese-American artist Jun Kaneko was awarded the contract. His concept included sculptural pots on a striped outdoor plaza. Bomanite Licensee, Musselman & Hall Contractors were chosen to implement the striped plaza surface. This was achieved by pouring a SandScape Textured Bomanite finish using an integrally colored white cement-based concrete mix. Diagonal sawcuts were installed with a v-shaped blade @ 12" on center. Alternate bands were stained using Black Bomanite Con-Color. To protect the surface from the elements Bomanite Conshield was applied to the entire job as well as Bomanite Bomaseal C-27 Solvent Sealer.

Bomanite SandScape® Texture is designed for outdoor applications where an alternate to a conventional concrete finish is required. Utilizing specialized mix designs, additives, topical treatments and advanced application procedures, Bomanite SandScape® Texture resembles sand blasted concrete and can incorporate specialized colored sands and/or aggregates exceeding 3/8" diameter. The finish is an economical alternate to other decorative concrete finishes while producing a monolithic concrete slab at low life-cycle cost due to the pre-aged nature of the surface. Used in combination with a variety of color and staining options, Bomanite SandScape® Texture creates consistent texture and durable hardscapes ideal for plazas, walkways, shopping centers, schools and more.

PROJECT DETAILS

LOCATION

Kansas City, MO

CLIENT

City of Kansas City, MO

PROJECT DESIGNER

Jun Kaneko Studios

INSTALL COMPLETED

April 2007

SQUARE FEET

8,500

BOMANITE SYSTEMS

Exposed Aggregate - Bomanite SandScape® Texture
Bomanite Con-Color

BOMANITE LICENSED CONTRACTOR

Musselman & Hall Contractors, LLC

4922 E. Blue Banks

Kansas City, MO 64130

TEL: 816-861-1234

FAX: 816-861-1237

Email: dkroesen@mandh.net

Website: www.mandh.net

Bomanite Exposed Aggregate Systems

PROJECT PROFILE

BARTLE HALL BALLROOM WATER PLAZA



Bartle Hall Ballroom Water Plaza - Sandstone Texture with Bomanite Con-Color



Bartle Hall Ballroom Water Plaza - Sandstone Texture with Bomanite Con-Color



Bartle Hall Ballroom Water Plaza - Sandstone Texture with Bomanite Con-Color



Bartle Hall Ballroom Water Plaza - Sandstone Texture with Bomanite Con-Color

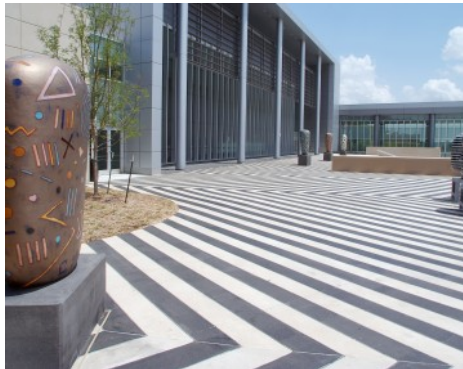

Bartle Hall Ballroom Water Plaza - Sandstone Texture with Bomanite Con-Color



Bartle Hall Ballroom Water Plaza - Sandstone Texture with Bomanite Con-Color



Bartle Hall Ballroom Water Plaza - Sandstone Texture with Bomanite Con-Color



Bartle Hall Ballroom Water Plaza - Sandstone Texture with Bomanite Con-Color



Bartle Hall Ballroom Water Plaza - Sandstone Texture with Bomanite Con-Color

Bomanite Exposed Aggregate Systems

PROJECT PROFILE

BARTLE HALL BALLROOM WATER PLAZA



Bartle Hall Ballroom Water Plaza - Sandstone Texture
with Bomanite Con-Color